



IV Pole
Fixed height

for use with stretcher series

5110, 5400, 7500, 7500^{NE}

Part No.: 2101



IV Pole

Easiloc 7/8" adjustable removable

for use with stretcher series

5110, 5400, 7500, 7500^{NE}

Part No.: 5984001



IV Pole Adjust

With storage tube & cable

for use with stretcher series

5110^N, 5400^N, 7500^N

Part No.: 750501



IV Pole Adjust

With storage tube & cable

for use with stretcher series

5110^W, 5400^W, 7500^W

Part No.: 750502



IV Pole Adjust

With storage tube & cable

for use with stretcher series

7500^{NE}

Part No.: 750702



IV Pole

Fold Down

for use with stretcher series

5110, 5400, 7500, *7500^{NE}

Part No.: 59175001

** foot end only*



IV Pole

Pediatric Crib

for use with stretcher series

500

Part No.: 5116001



IV Caddy

for use with stretcher series

5110, 5400, 7500

Part No.: 59163001

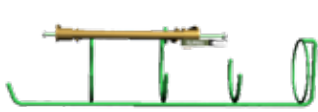

O₂ Tank Holder

for use with stretcher series

5110, 5400, 7500, 7500^{NE}

Part No.: 750213

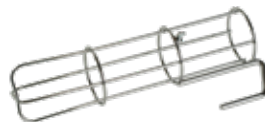

O₂ Holder

Vertical

for use with stretcher series

5110, 5400, 7500, 7500^{NE}

Part No.: 5981001



Paper Roll Holder 18"

(exc. Knee Flex)

for use with stretcher series

5110, 5400, 7500

Part No.: 5966001



O₂ Holder

Pediatric Crib

for use with stretcher series

500

Part No.: 5114001



Head/Foot Extension
Without Pad

for use with stretcher series

5110, 5400, 7500, *7500^{NE}

Part No.: 5996001

* Can not be used if stretcher has patient bag hook installed.



Head/Foot Extension Pad
3" Pad

for use with stretcher series

5110, 5400, 7500

Part No.: 5708001

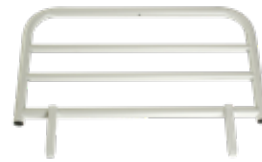

Push/Pull Bar
Removable

for use with stretcher series

5110, 5400, 7500, *7500^{NE}

Part No.: 5985001 (narrow)
Part No.: 5986001 (wide)

* Can not be used if stretcher has patient bag hook installed.



Push/Pull Bar Pad

for use with stretcher series

5110, 5400, 7500, 7500^{NE}

Part No.: 5704001 (narrow)
Part No.: 5705001 (wide)



Siderail Pads
Pair

for use with stretcher series

5110, 5400

Part No.: 5701002



Siderail Pads
Pair

for use with stretcher series

7500

Part No.: 5716001



Surgical Arm Board Pad
With Pad

for use with stretcher series

5110, 5400, 7500

Part No.: 59121001 (3" Pad)
Part No.: 59122001 (4" Pad)



Restraint Straps
Pair

for use with stretcher series

5110, 5400, 7500, 7500^{NE}

Part No.: 5903001 (Velcro)
Part No.: 5904001 (buckle)



Stirrups
Set

for use with stretcher series

5110, 5400, 7500, 7500^{NE}

Part No.: 5910001

Requires: 5994001

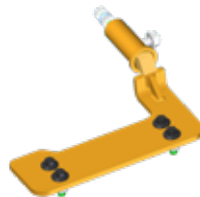

Trendelenburg Level Lock

for use with stretcher series

5110

Part No.: 750217



Exit Monitor

for use with stretcher series

5110, 5400, 7500

Part No.: 750216



**Monitor Tray Board w/
Chart Holder**

for use with stretcher series

5110, 5400, 7500, 7500^{NE}

Part No.: 59115001 (narrow)
Part No.: 59116001 (wide)



Chart Holder

for use with stretcher series

5110, 5400, 7500, 7500^{NE}

Part No.: 5967001
Requires: 5985001, 5986001,
59115001, or 59116001



Push/Pull Handles
CuVerro®

for use with stretcher series

5400, 7500

Part No.: 750223 (narrow)
Part No.: 750224 (wide)





Siderail Bumper Pads
Pediatric Crib

for use with stretcher series

500

Part No.: 5109002



Utility Shelf
Pediatric Crib

for use with stretcher series

500

Part No.: 5103001



Security Top
Translucent Smoke for Crib

for use with stretcher series

500

Part No.: 5117001



Security Top - Removable
Translucent Smoke for Crib

for use with stretcher series

500

Part No.: 5107001
Includes 6 mounting clips



Storage Bag Hook

for use with stretcher series

5110, 5400, 7500

Part No.: 750215



Storage Bag Hook

for use with stretcher series

7500^{NE}

Part No.: 750706



Battery Charging Station

for use with stretcher series

7500^{NE}

Part No.: 750711



Battery - Rechargeable

for use with stretcher series

7500^{NE}

Part No.: 750720



Complete 7 Piece Head & Neck Pad Kit

for use with stretcher series

7500^{NE}

Part No.: 750701



Surgeon Swivel Wrist Rest

for use with stretcher series

7500^{NE}

Part No.: 750709
Part No.: 750709-1 (3" extension)



Surgeon Wrist Rest

for use with stretcher series

7500^{NE}

Part No.: 750703



Head Rest Extension
With Integrated Push Handle

for use with stretcher series

7500^{NE}

Part No.: 750704

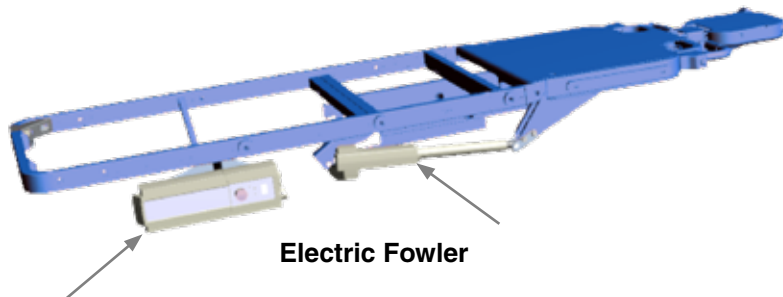

Electric Fowler

for use with stretcher series

7500^{NE}

Part No.: 750705