



**IV Pole**  
Fixed height

*for use with stretcher series*

**5110, 5400, 7500, 7500<sup>NE</sup>**

**Part No.: 2101**



**IV Pole**  
Easiloc 7/8" adjustable removable

*for use with stretcher series*

**5110, 5400, 7500, 7500<sup>NE</sup>**

**Part No.: 5984001**



**IV Pole Adjust**  
With storage tube & cable

*for use with stretcher series*

**5110<sup>N</sup>, 5400<sup>N</sup>, 7500<sup>N</sup>**

**Part No.: 750501**



**IV Pole Adjust**  
With storage tube & cable

*for use with stretcher series*

**5110<sup>W</sup>, 5400<sup>W</sup>, 7500<sup>W</sup>**

**Part No.: 750502**



**IV Pole Adjust**  
With storage tube & cable

*for use with stretcher series*

**7500<sup>NE</sup>**

**Part No.: 750702**



**IV Pole**  
Fold Down

*for use with stretcher series*

**5110, 5400, 7500, \*7500<sup>NE</sup>**

**Part No.: 59175001**

*\* foot end only*



**IV Pole**  
Pediatric Crib

*for use with stretcher series*

**500**

**Part No.: 5116001**



**IV Caddy**

*for use with stretcher series*

**5110, 5400, 7500**

**Part No.: 59163001**

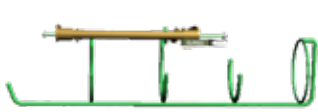

**O<sub>2</sub> Tank Holder**

*for use with stretcher series*

**5110, 5400, 7500, 7500<sup>NE</sup>**

**Part No.: 750213**

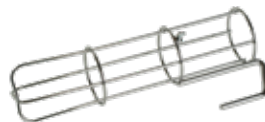

**O<sub>2</sub> Holder**  
Vertical

*for use with stretcher series*

**5110, 5400, 7500, 7500<sup>NE</sup>**

**Part No.: 5981001**



**Paper Roll Holder 18"**  
(exc. Knee Flex)

*for use with stretcher series*

**5110, 5400, 7500**

**Part No.: 5966001**



**O<sub>2</sub> Holder**  
Pediatric Crib

*for use with stretcher series*

**500**

**Part No.: 5114001**



**Head/Foot Extension**  
Without Pad

*for use with stretcher series*

**5110, 5400, 7500, \*7500NE**

**Part No.: 5996001**

\* Can not be used if stretcher has patient bag hook installed.



**Head/Foot Extension Pad**  
3" Pad

*for use with stretcher series*

**5110, 5400, 7500**

**Part No.: 5708001**

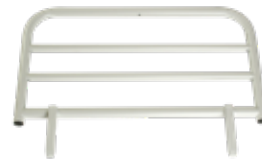

**Push/Pull Bar**  
Removable

*for use with stretcher series*

**5110, 5400, 7500, \*7500NE**

**Part No.: 5985001 (narrow)**  
**Part No.: 5986001 (wide)**

\* Can not be used if stretcher has patient bag hook installed.



**Push/Pull Bar Pad**

*for use with stretcher series*

**5110, 5400, 7500, 7500NE**

**Part No.: 5704001 (narrow)**  
**Part No.: 5705001 (wide)**



**Siderail Pads**  
Pair

*for use with stretcher series*

**5110, 5400**

**Part No.: 5701002**



**Siderail Pads**  
Pair

*for use with stretcher series*

**7500**

**Part No.: 5716001**



**Transfer Board**  
With Pad

*for use with stretcher series*

**5110, 5400, 7500**

**Part No.: 750724 (4" Pad)**



**Surgical Arm Board Pad**  
With Pad

*for use with stretcher series*

**5110, 5400, 7500**

**Part No.: 59121001 (3" Pad)**  
**Part No.: 59122001 (4" Pad)**



**Restraint Straps**  
Pair

*for use with stretcher series*

**5110, 5400, 7500, 7500NE**

**Part No.: 5903001 (Velcro)**  
**Part No.: 5904001 (buckle)**



**Stirrups**  
Set

*for use with stretcher series*

**5110, 5400, 7500, 7500NE**

**Part No.: 59100001**

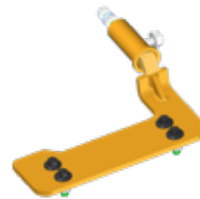

**Trendelenburg Level Lock**

*for use with stretcher series*

**5110**

**Part No.: 750217**



**Exit Monitor**

*for use with stretcher series*

**5110, 5400, 7500**

**Part No.: 750216**



**Monitor Tray Board w/  
Chart Holder**

*for use with stretcher series*

**5110, 5400, 7500, 7500NE**

**Part No.: 59115001 (narrow)**  
**Part No.: 59116001 (wide)**



**Chart Holder**

*for use with stretcher series*

**5110, 5400, 7500, 7500NE**

**Part No.: 5967001**  
Requires: 5985001, 5986001,  
59115001, or 59116001



**Push/Pull Handles**  
**CuVerro®**

*for use with stretcher series*

**5400, 7500**

**Part No.: 750223 (narrow)**  
**Part No.: 750224 (wide)**



**Siderail Bumper Pads**  
Pediatric Crib

*for use with stretcher series*

**500**

**Part No.: 5109002**



**Utility Shelf**  
Pediatric Crib

*for use with stretcher series*

**500**

**Part No.: 5103001**



**Security Top**  
Translucent Smoke for Crib

*for use with stretcher series*

**500**

**Part No.: 5117001**



**Security Top - Removable**  
Translucent Smoke for Crib

*for use with stretcher series*

**500**

**Part No.: 5107001**  
*Includes 6 mounting clips*



**Storage Bag Hook**

*for use with stretcher series*

**5110, 5400, 7500**

**Part No.: 750215**



**Storage Bag Hook**

*for use with stretcher series*

**7500<sup>NE</sup>**

**Part No.: 750706**



**Battery Charging Station**

*for use with stretcher series*

**7500<sup>NE</sup>**

**Part No.: 750711**



**Battery - Rechargeable**

*for use with stretcher series*

**7500<sup>NE</sup>**

**Part No.: 750720**



**Complete 7 Piece Head & Neck Pad Kit**

*for use with stretcher series*

**7500<sup>NE</sup>**

**Part No.: 750701**



**Surgeon Swivel Wrist Rest**

*for use with stretcher series*

**7500<sup>NE</sup>**

**Part No.: 750709**  
**Part No.: 750709-1** (3" extension)



**Surgeon Wrist Rest**

*for use with stretcher series*

**7500<sup>NE</sup>**

**Part No.: 750703**



**Head Rest Extension**  
With Integrated Push Handle

*for use with stretcher series*

**7500<sup>NE</sup>**

**Part No.: 750704**

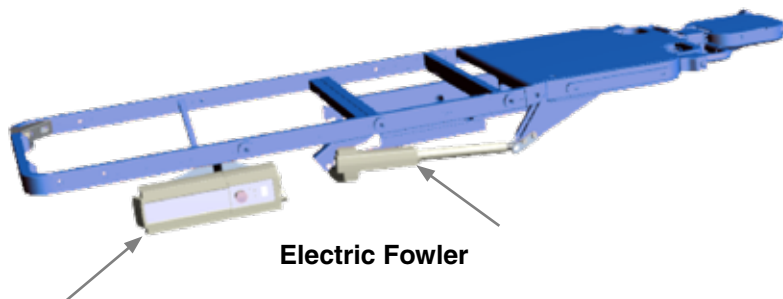

**Electric Fowler**

*for use with stretcher series*

**7500<sup>NE</sup>**

**Part No.: 750705**